

Flue gas analysis computer MAXILYZER NG



TÜV By RgG 210

Special features:

- Dust and waterproof device housing with vent valve
- Maximum sensor equipment: O₂, COH₂, NO, CO_{20,000} and SO₂
- 4 measured values on bright, backlit LCD
- Additional flushing function, depending on measured concentration
- Automatic device monitoring
- CO limit value monitoring with sensor protection function
- Graphical evaluation of measured values, combustion chart (online function)
- Innovative sensor core with selective filter replacement for prolonged service life
- Powerful battery, approx. 24 hours of operation with active display backlit function
- Intelligent charging technology via external power supply unit
- Hold function, zoom function, core search function, conversion of units

MAXILYZER NG

This flue gas analysis computer with state-of-the-art technology and modern design features an integrated printer and gas treatment unit. The sturdy, waterproof plastic housing contains the microprocessor-controlled electronic system, the electrochemical measuring cells and sensors and the flue gas distribution system. Optimised gas distribution to the sensors and an automatic CO flushing function via a second pump protect the sensors. An efficient gas treatment system is integrated in the case lid.

Measured parameters: : O₂, CO_{H2}, (Options: CO_{20,000}, NO and SO₂), flue gas temperature, combustion air temperature, differential pressure, differential temperature.

Calculated parameters:

CO absolute, lambda, CO₂, efficiency η , flue gas losses qA. 15-minute mean value programme for solid fuels.

When the lid is opened, all operating and connection elements are easily accessible at the upper side of the analyser. The connection pieces for pressure, temperature, charger, RS232 interface and connections for the flue gas combination probe are located at the left side. The large, backlit graphical display is located at the top centre. Below the display are

3 soft keys. The integrated thermal printer for hardcopies on printer paper can be found at the bottom. A foil keypad can be found at the right side.

The display has four lines with an additional status line, graphical representation, zoom and hold functions as well as an electronic core search function and sensor status diagnostics. Specially designed for the optimisation of solid fuel, pellet and condensing systems. The triple stage gas treatment unit is integrated in the case lid. It features a condensate cartridge, a drying cartridge with drying beads and a dust cartridge with Infiltec dust filter.

This unit protects the analyser from humidity and dirt. The system is also equipped with the following components: memory for 100 to up to 250 measurement blocks, rechargeable battery for 24 hours of operation and power supply unit with intelligent quick-charge technology.

Scope of delivery

MAXILYZER NG with 2, 3 or 4, max. 6 sensors.

Case with battery charger, ambient air sensor, flue gas combination probe, operating instructions and accessories.

TÜV By RgG 210

DG: H	Part no.	Price €
MAXILYZER NG O ₂ , CO _{H2}	69233	
MAXILYZER NG O ₂ , CO _{H2} , NO	69234	
MAXILYZER NG O ₂ , CO _{H2} , CO _{20,000}	69237	
MAXILYZER NG O ₂ , CO _{H2} , CO _{20,000} , NO	69235	
Spare parts		
Ambient air sensor (stub sensor)	69196	
Flue gas combination probe	69197	
Case for flue gas combination probe and accessories	69198	
Battery charger	69199	
Options: Immediate installation when instrument is ordered		
CO-20,000 ppm with solid fuel program	69535	
SO ₂ -2,000 ppm	69537	
Printer paper (5 rolls)	69182	
Ink ribbon	24 02 000304	
Bluetooth	69236	
Please enquire for maintenance contracts.		

Flue gas analysis computer MAXILYZER NG



Technical specifications

Flue gas temperature

Measuring range: 0 °C/+1,000 °C
Resolution: 1 °C
Thermocouple: NiCr-Ni (type K)

Outside wall/air temperature

Measuring range: -20 °C/+200 °C
Resolution: 0.1 °C
Thermocouple: NiCr-Ni (type K)

Draft/differential pressure

Measuring range: ±150 mbar
Resolution: 0.01 hPa

O₂ measurement

(electrochemical measuring cell)
Measuring range: 0/20.9 % by vol.
Resolution: 0.1 % by vol.

CO₂ determination

(calculation on the basis of O₂)
Range: 0/CO₂ max.
Resolution: 0.1 % by vol.

CO measurement

(electrochemical measuring cell, with
H₂ compensation):
Measuring range: 0/4,000 ppm
Resolution: 1 ppm

Options

CO measurement solid fuels

(without H₂ compensation):
Measuring range: 0/2.0 % by vol.
(20,000 ppm)
Resolution: 0.01 % by vol.

NO measurement

(electrochemical measuring cell)
Measuring range: 0/2,000 ppm
Resolution: 1 ppm

SO₂ measurement

(electrochemical measuring cell)
Measuring range: 0/2,000 ppm
Resolution: 1 ppm

Weight: Approx 2.8 kg

Dimensions

W x H x D: 273 x 125 x 247 mm

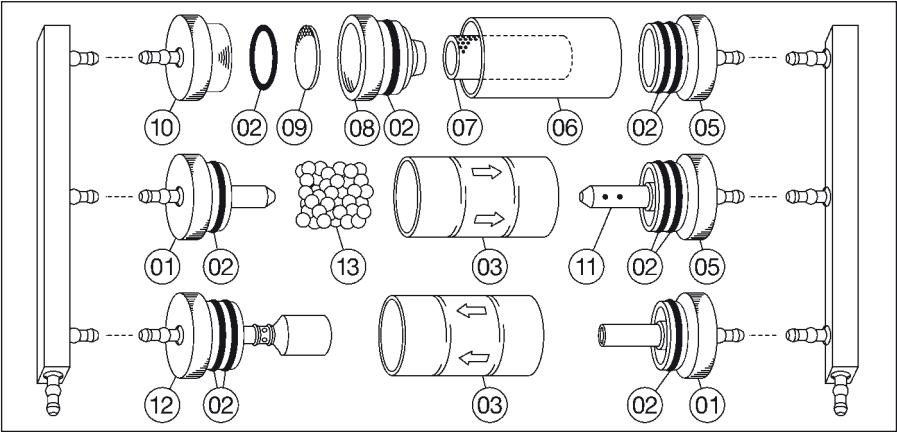

Gas treatment system for MAXILYZER / MAXILYZER NG

Maintenance information

Handle the gas treatment system
with patented water stop system
with special care in order to ensure
maximum protection of your MAXI-
LYZER analysis computer.

Ensure that the following parts are
replaced in good time:

09 Teflon membrane

07 Infiltec fine filter

13 Drying beads

It is recommended to order these
parts along with the system.

DG: H	Part no.	Price €
Spare parts for the gas treatment system MAXILYZER/MAXILYZER NG		
01 Inlet piece	695 000 94	
02 Assortment of O rings	69427	
03 Glass piston with arrow	695 000 95	
05 Inlet piece particle filter element	695 000 93	
06 Glass piston with logo	695 000 99	
07 Infiltec fine filter, 5 pieces	69412	
08 Intermediate piece	695 000 97	
09 Teflon membrane Ø 23.5 mm, 10 pieces.	69206	
10 Outlet piece	695 000 98	
11 Filter pipe M6	695 000 92	
12 Outlet piece with cylinder	695 000 91	
13 Drying beads, 850 ml can	69226	
Please enquire about maintenance contracts.		