

# Twin thermostats with housing GDT



## Type GDT/8RR

Twin thermostat with housing, with immersion stem and pocket, with 2 control thermostats, adjustable from outside.

### Operating ranges

0/60 °C – 30/120 °C  
0/90 °C – 30/120 °C

### Tolerance

±3 K

### Switching differential

5 K ±1 K

### Probe element

Liquid-filled

### Pocket

Cu alloy, connection 1/2-14 NPT

### Stem length

100 mm

### Housing

Base plate galvanised sheet steel  
Upper part and adjustment knobs ABS  
(UL 94 V0)

### Housing protection

IP 40

### Electrical connections

Cable gland PG 11

### Contact rating

K1 16 (4) A 250V AC  
K1-2 06 (1) A 400V AC

### Switching schematic

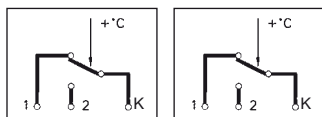

### Approvals



## Type GDT/8HR

Twin thermostat with housing, with immersion stem and pocket, with 2 control thermostats, 1 x adjustable from inside, 1 x adjustable from outside.

### Operating ranges

0/60 °C – 30/120 °C  
0/90 °C – 30/120 °C

### Tolerance

±3 K

### Switching differential

5 K ±1 K

### Probe element

Liquid-filled

### Pocket

Cu alloy, connection 1/2-14 NPT

### Stem length

100 mm

### Housing

Base plate galvanised sheet steel  
Upper part and adjustment knob ABS  
(UL 94 V0)

### Housing protection

IP 40

### Electrical connections

Cable gland PG 11

### Contact rating

K1 16 (4) A 250V AC  
K1-2 06 (1) A 400V AC

### Switching schematic

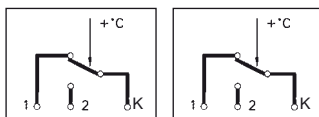

### Approvals



## Type GDT/8RS

Twin thermostat with housing, with immersion stem and pocket, consisting of temperature control thermostat (TRT), adjustable from outside, and safety temperature switch (STB) with manual reset.

### Operating ranges (switch point STB)

0/60 °C (100 °C)  
0/90 °C (100 °C)

### Switch point accuracy

TRT ±3 K/STB +0/-6 K

### Switching differential

TRT 5 K ±1 K/STB 15 – 25 K

### Probe element

Liquid-filled

### Pocket

Cu alloy, connection 1/2-14 NPT

### Stem lengths

100, 150, 200 mm

### Housing

Base plate galvanised sheet steel  
Upper part and adjustment knob ABS  
(UL 94 V0)

### Housing protection

IP 40

### Electrical connections

Cable gland PG 11

### Contact rating

K1 16 (4) A 250V AC  
K1-2 6 (1) A 400V AC

### Switching schematic STB

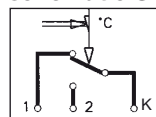

### Switching schematic TRT

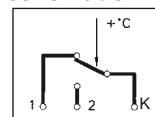

### Approvals



# Twin thermostats with housing GDT

Dimensions (in mm)

**Type GDT/8RR**

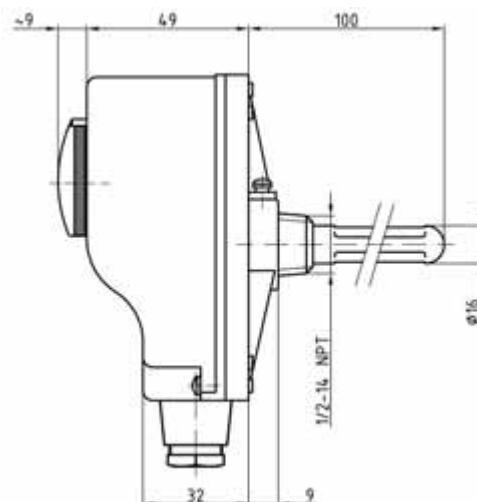
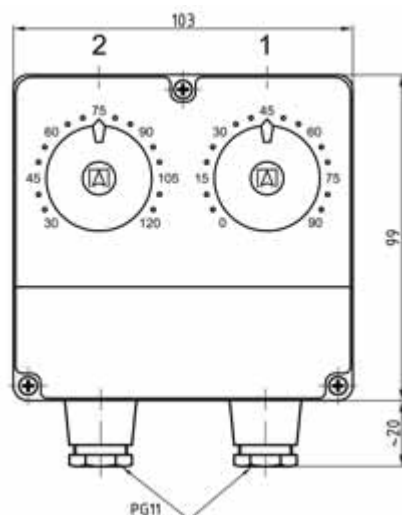

**Type GDT/8HR**

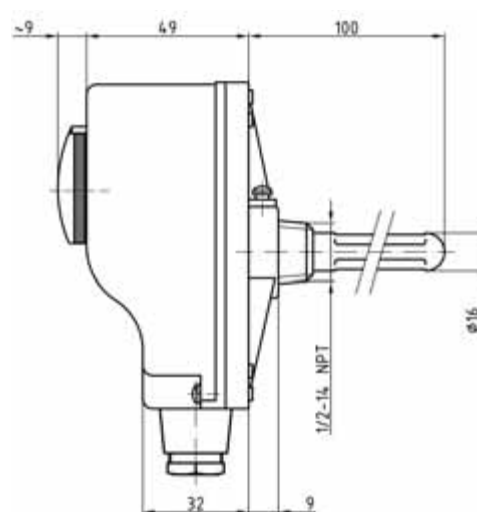
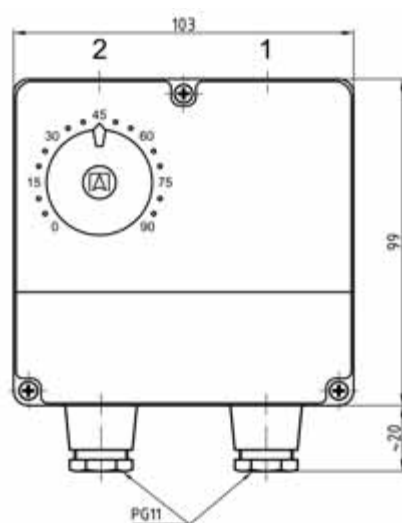

**Type GDT/8RS**

