

# Pressure transducer DMU 01K

## Compact version

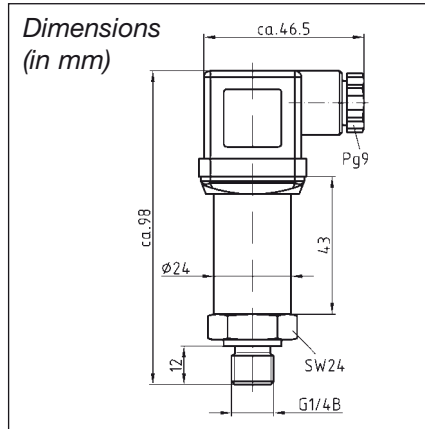

Wiring diagram

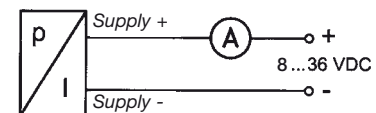

### Application

Special OEM unit. For electronic pressure measurement in industrial or HVAC applications (such as hydraulic, pneumatic, automation, heating or air conditioning).

### Description

The DMU 01K pressure transducers use proven ceramic measuring cell technology and feature calibrated, amplified sensor signals which are available as standardised current outputs.

#### DMU 01K features:

- Compact design
- Superior price/performance ratio due to automated mass production
- High temperature resistance
- No mechanical ageing

### Accuracy of measurement

Deviation characteristics according to IEC 60770 - limit point setting (non-linearity, hysteresis, repeatability):  $< \pm 1 \% \text{ FSO}$   
(meas. ranges  $\geq 0/100 \text{ bar}$   $< \pm 2 \% \text{ FSO}$ )

### Measuring ranges

Relative pressure: 0/1.6 to 0/250 bar

### Overpressure safety

At least 2 x FS  
(burst pressure at least 3 x FS)

### Operating temperature range

Medium:  $-25^\circ\text{C}/+125^\circ\text{C}$   
Ambient:  $-25^\circ\text{C}/+85^\circ\text{C}$   
Storage:  $-40^\circ\text{C}/+85^\circ\text{C}$

### Temperature error band

In compensated range  
 $-25/+85^\circ\text{C} \leq 0.5 \% \text{ FSO}/10 \text{ K}$

### Dynamic characteristics

Response time  $< 10 \text{ ms}$

### Process connection

G1/4B, DIN 3852

### Materials

Housing: stainless steel 1.4301  
Pressure-connection: stainless steel 1.4301  
Diaphragm: ceramic  $\text{Al}_2\text{O}_3$  96 %  
Seal: FKM (Viton)

### Supply voltage

DC 8–36 V

### Output signal

4–20 mA, 2-wire

### Load

$4-20 \text{ mA} \leq \frac{U_B - U_{B,min}}{0,02 \text{ A}}$

### Current input

4–20 mA  $< 25 \text{ mA}$

### Protective electrical measures

Short circuit proof and polarity protected

### Electrical connection (protection)

Plug and junction box  
DIN 43650-A (IP 65)

### CE conformity (EMC)

EMC directive 2004 / 108 / EG

### Options

- Fixed cable connection
- Other output signals
- Other connection threads